

# FRASER WHARVES PORT METRO VANCOUVER

## FRASER RIVER FLOW

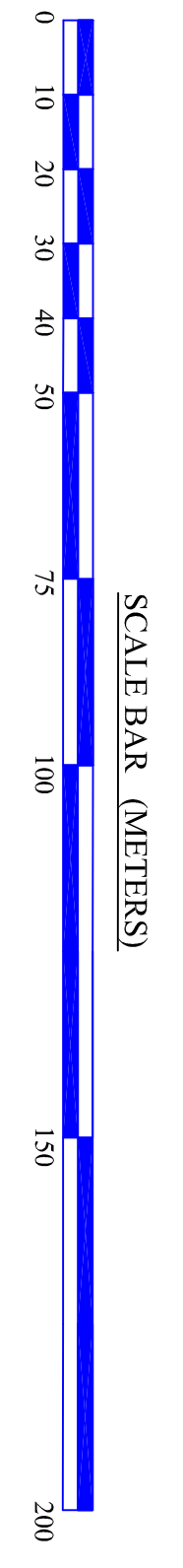
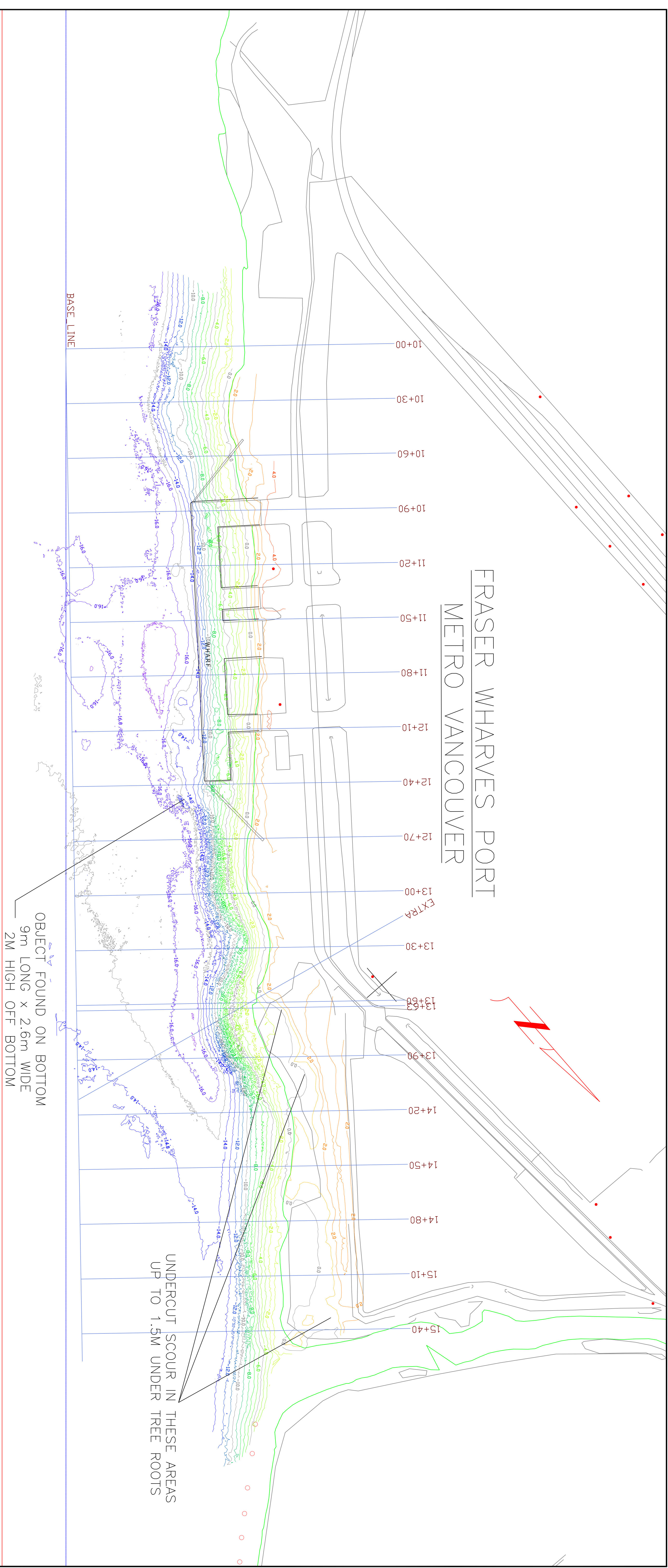

- EQUIPMENT:**
1. RESON SEABAT 8124 MULTI-BEAM ECHOSOUNDER
  2. MOTION COMPENSATION BY ISS DMS205
  3. HEADING SENSOR HEMISPHERE VS 110 OPS
  4. DATA COLLECTION AND PROCESSING SOFTWARE HYPACK MAX
  5. SOUND VELOCITY BY APPLIED MICRO SYSTEMS SYRPLUS

- NOTES:**
1. HORIZONTAL AND VERTICAL POSITIONING BY TRIMBLE R8 GNSS RTK/PPS RECEIVER, TO UTM ZONE 10 GRID MAG 83.
  2. SOUNDINGS OBTAINED USING A MULTI-BEAM SONAR ECHOSOUNDER SEE EQUIPMENT LIST ABOVE.
  3. DEPTHS ARE METERS AND ARE REDUCED TO GEODETIC DATUM CQD28. CONVERSION TO CHART DATUM 1.80M
  4. CONTOUR INTERVAL IS 1.0 M.
  5. ELEVATIONS DERIVED FROM VRS+ CANNET RIK BASE STATION NETWORK. CHECKED HORIZONTAL AND VERTICAL DATUMS AT BENCHMARK 8440431
  6. REFERENCES DRAWING FOR BACKGROUNDS SUPPLIED BY EBA AND PWSC.
  7. ALL INFORMATION OF THIS PLAN IS REPRESENTATIVE OF CONDITIONS AT TIME OF SURVEY.

**CPA - Canada Surveys Inc.**  
 INTERNATIONAL SURVEYS AND MARINE INVESTIGATIONS  
 3859 JAYCE DRIVE  
 2170 MAZE RD  
 VANCOUVER, BC V6M 2G4  
 TEL: 604-273-8909  
 WWW.CANADASURVEYS.COM

X	APR-16-2012	FRASER WHARVES CONDITION SURVEY	HHH	HHH	APR/12
NO.	DATE	DESCRIPTION	ISSUE	REVISIONS	

<b>CLIENT:</b>		<b>DRAWING TITLE:</b>	
EBA_TETRA TECH	DATE: 04/16/2012	1.0 CONTOUR DRAWING, FRASER WHARVES GEODETIC DATUM, KM 19 FRASER RIVER, RICHMOND, BC	
<b>PROJECT:</b>		<b>DRAWING SCALE:</b>	<b>JOB NO.:</b>
HYDROGRAPHIC SURVEY FRASER WHARVES		1:1000	372-12
<b>SURVEYED BY:</b>	<b>PROCESSED BY:</b>	<b>DRAWING NO.:</b>	<b>REV.:</b>
HHH/RCC	HHH	372_04132012	A
<b>SURVEY DATE:</b>	<b>PROCESSING DATE:</b>		
04-12/13-2012	04-15-2012		